

# DigiDocFlow®



## & Worldox GX®

## Experience the simplicity of scanning directly into Worldox GX

With DigiDocFlow it's very easy to use the application which you already use for the storage of information for the storage of scanned documents as well. DigiDocFlow makes scanning and archiving easy. All documents can be digitalized without having to install software on local workstations. DigiDocFlow runs on a non-dedicated central server. In addition DigiDocFlow is a middleware application, which means that the user does not 'see' the software while working with it. Benefit of this is that product training is not necessary. Everyone can use it straight away.

Worldox GX® is comprehensive, practical, sensible document management for the real world. Using Worldox GX, you can give your people fast, easy access to all the information and knowledge you own, from word processing files and spreadsheets to emails and scanned documents even voice mails – virtually anything that can be stored as a file.



## Easy scanning

In Worldox scanned documents can be stored in every profile and folder within Worldox.

## DigiDocFlow - Experience simplicity

Key Benefits:

- Your documents stored directly in Worldox
- Bidirectional communication
- Save time and money
- Optimising efficiency
- Text searchable files

DigiDocFlow®



# Scan directly to Worldox GX

Through an online connection between DigiDocFlow and Worldox it's possible to select the correct profile and folder directly on the display of the multifunctional. DigiDocFlow displays a real time list of, for example, clients generated from Worldox on the display of the multifunctional. Users can then select the location where they want to store their document within Worldox. DigiDocFlow will store the scanned document directly in the correct folder in Worldox. .

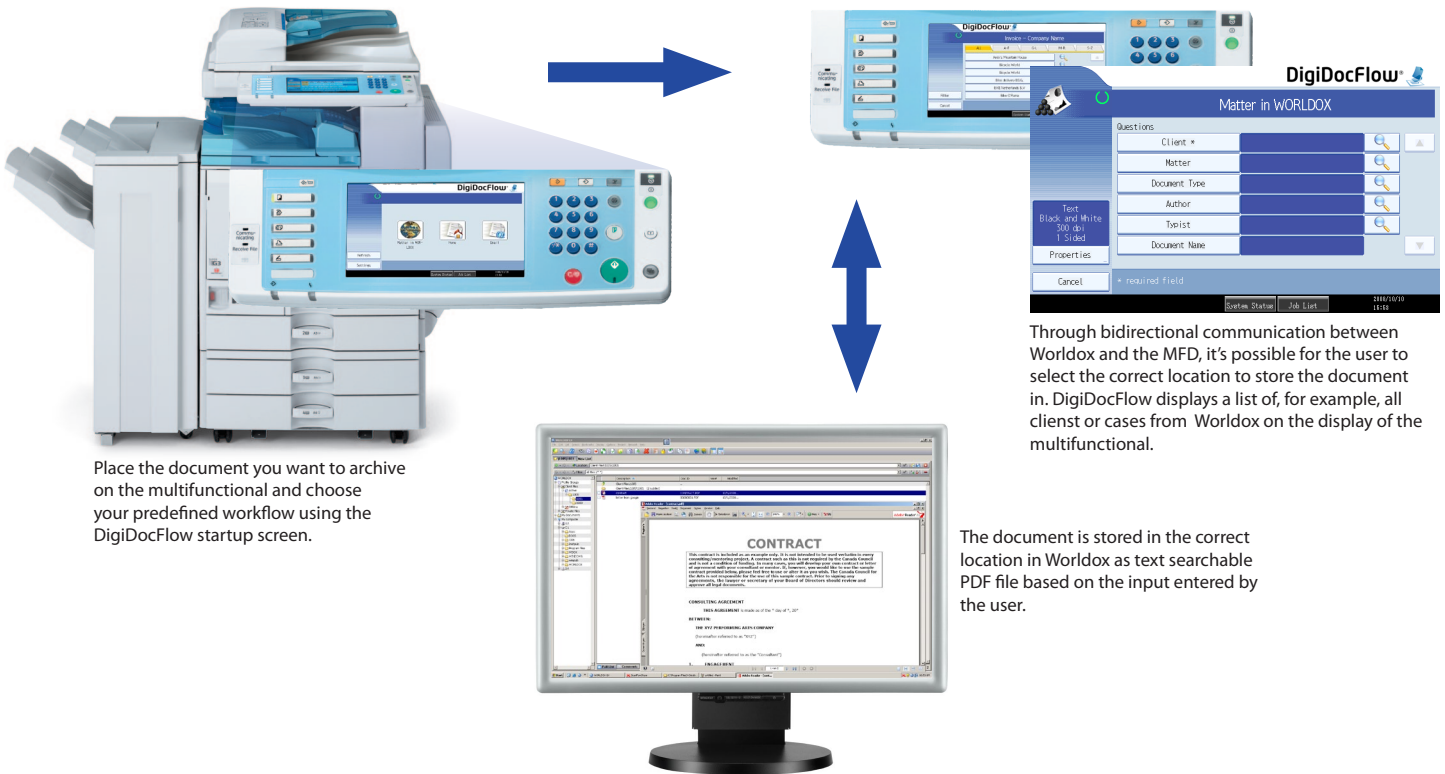

## Contact

### Nuance Communications, Inc.

Worldwide Headquarters  
1 Wayside Road  
Burlington, MA 01803  
United States  
E info@digidocflow.com

For more information please contact your local representative, Nuance Communications or check [www.digidocflow.com](http://www.digidocflow.com).

### Nuance Communications

**International**  
Guldensporenpark 32  
9820 Merelbeke  
Belgium  
E info@digidocflow.com